

cercon
smart ceramics

Cercon clean Instructions for Use

Designation of the unit:
Single-user vacuum-
cleaner unit

Dear Customer:

Thank you for the confidence in our work that you showed us by buying this vacuum-cleaner unit.

In order for you be able to enjoy your unit and its capabilities for many years, please take the time to read these Instructions for Use carefully, especially before using the unit for the first time.

Contents

1 Safety	5
1.1 Proper use	5
1.2 Potential hazards	5
1.3 Authorized operators	5
1.4 Safety precautions at the deployment site	5
1.5 Conventions used for the safety instructions in these Instructions for Use	5
2 Commissioning	6
2.1 Unpacking the single-user vacuum-cleaner unit	6
2.2 Short description of the unit – Identification of components	7
2.3 Turning on the unit	7
2.4 Electrically connecting the unit	7
3 Operation	7
3.1 Checking the filtration module	7
3.2 Air volume control	8
3.3 Automatic turn-off and filter change indicator	8
4 Cleaning and maintenance	8
4.1 Replacing the filter bag	8
4.2 Inserting the filter bag	9
4.3 Cleaning (replacing) the ultra-fine filter	9
4.4 “Service” indicator	10
5 Electrical protection	10
6 Technical specifications	10
7 Warranty conditions	10
8 EU Declaration of Conformity	11

1 Safety

1.1 Proper use

The CERCON CLEAN single-user vacuum-cleaning unit is used in dental laboratories for the removal of the dust generated when working with dust-producing machinery. It is not permitted to attempt to use this unit for the removal of liquids.

This vacuum-cleaning unit is suitable for removing Category C dust as per the requirements of the German employers mutual insurance associations pursuant to DIN EN 60 335-269 (ZH 1/487).

Unauthorized changes and modifications are prohibited for safety reasons.

Compliance with the operation and service conditions laid down in these Instructions for Use is mandatory.

Caution: This unit was not designed as a medical device. Its use on humans is not permitted!

1.2 Potential hazards

- Do not vacuum any sources of ignition and no flammable gases, fumes and liquids.
- Turn off the unit using the mains switch before any maintenance, cleaning or repair work, and physically disconnect from mains (by unplugging the mains cable).
- Because the vacuumed dust can constitute a health hazard, care must be taken and insure that the filter bag and the ultra-fine filter are inserted correctly at all times and that they are undamaged.
- Before accessing the electrical component of the unit, the unit must be disconnected from mains.

1.3 Authorized operators

The person or entity responsible for the operation of the unit must provide the operator with the Instructions for Use and ensure that the latter has read and understood them. Not until this is ensured will the operator be permitted to operate the unit.

1.4 Safety precautions at the deployment site

The air from the air outlet (9) must be allowed to exit unimpeded.

The distance from the air outlet to the next obstacle (e.g. wall, piece of furniture) must be at least 10 cm.

The unit must only be used inside cabinets or small rooms if proper ventilation is ensured. The ambient temperature must not exceed 25 °C.

Do not insert any foreign matter into the unit through the vent openings.

Danger: The unit is not suitable for use in rooms in which special conditions prevail (e.g. a corrosive or explosive atmosphere).

1.5 Conventions used for the safety instructions in these Instructions for Use

Note: Indicates a practical hint to the user or other particularly useful information.

Caution: Indicates a usage or mode of operation whose non-observance may result in irregular operation, damage to the unit or other problems.

Danger: Indicates dangerous situations which may result in bodily injury.

2 Commissioning

2.1 Unpacking the single-user vacuum-cleaning unit

1. Place the box on a level surface.
2. Remove the outer packaging material.
3. Push the packaging material always from the unit and seize the lower edge of the unit.
4. Two people must be present to lift the unit out of the box (weight approximately 25 kg).
5. Check to ensure that all components are present:
 - Documentation
 - Mains cable
 - Control cable
 - Vacuum hose, 40 mm in diameter, 2 m in length, with two 40-mm connecting ducts
 - Single-use filter bags, paper, 5 ea.

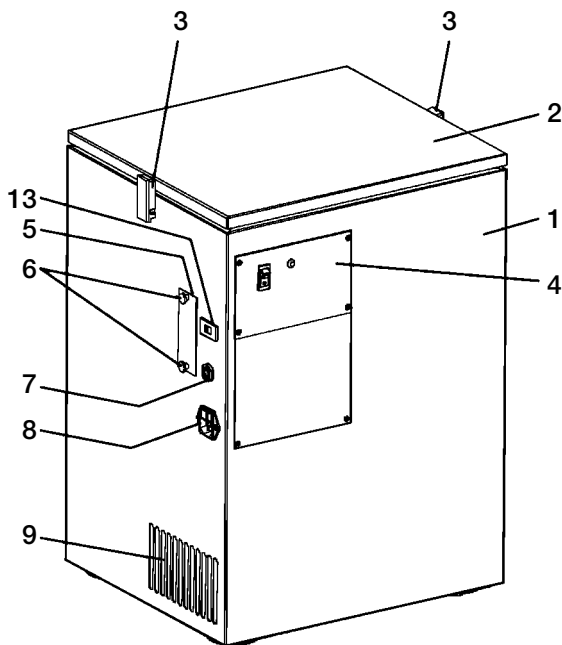

Fig. 1: View from front left

- 1 Casing
- 2 Cover
- 3 Clamp locks (2 ea.)
- 4 Panel
- 5 Mounting cover
- 6 Thumb screws (2 ea.)
- 7 Connection socket for control cable
- 8 Primary power socket (230 V/50 Hz)
- 9 Air outlet
- 13 Frequency selector 50/60 Hz

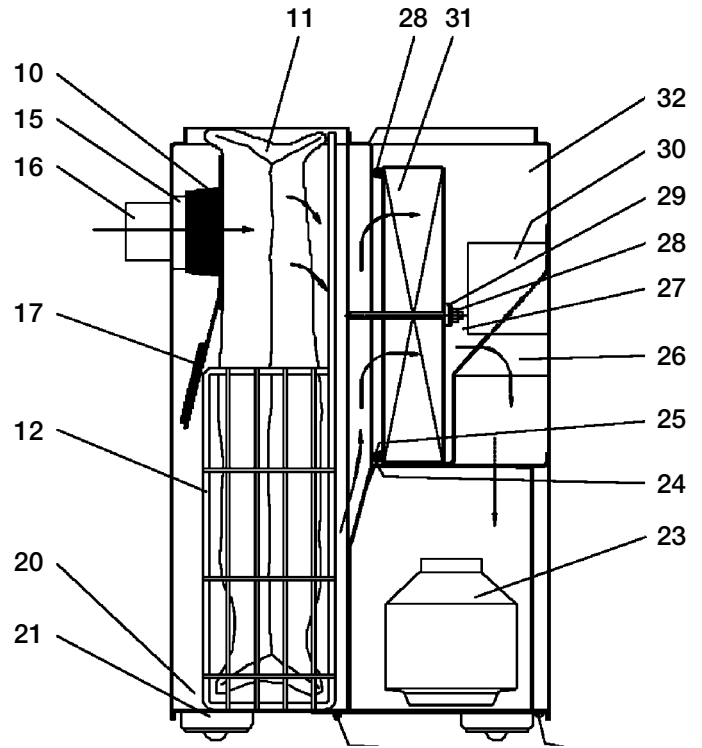

Fig. 2: Section through unit, viewed from the left

- 10 Plastic connector for filter bag
- 11 Filter bag
- 12 Basket
- 15 Duct, 63 mm in diameter
- 16 Duct, 40 mm in diameter
- 17 Cover for filter bag
- 20 Pre-filtration chamber
- 21 Floor rollers
- 22 Screws for bottom space (9 ea.)
- 23 Vacuum motor
- 24 Sealing surfaces, circumferential
- 25 Seal, circumferential
- 26 Air intake opening
- 27 Air intake chamber
- 28 M6 nuts (2 ea.)
- 29 Ledge with longitudinal bores
- 30 Electrical wiring central
- 31 Ultra-fine filter
- 32 Ultra-fine filtration chamber

2.2 Short description of the unit – Identification of components

The CERCON CLEAN single-user vacuum-cleaning unit features a powerful noise-reduced high-capacity pressure fan and is equipped with an internal potentiometer for regulating the amount of air, an automated power-off function and a filter change indicator.

The vacuum-cleaning unit can be operated on any voltage between 200 and 240 V without any effect on the preset input air volume.

The CERCON CLEAN is used as a vacuum accessory for dental milling units.

The vacuum function is turned on automatically as soon as the milling unit is activated.

The dust is collected in a double-layer single-use filter bag made of paper. The capacity of this filter bag can range up to 10 kg depending on the type of dust collected.

The large-area ultra-fine filter downstream from the single-use filter bag is capable of holding back Category C dust.

2.3 Turning on the unit

(see Figs. 1 and 2 on page 6)

1. Check the filtration module (see Section 3.1).
2. Connect the 40-mm diameter hose to the milling unit (keeping the hose as short as possible; the maximum length is approximately 2 m).
3. Connect the milling unit and the vacuum unit with the control cable included.
4. Connect the unit to mains (230 V/50 or 60 Hz).
5. Select the correct frequency using the frequency selector (13).
6. Turn on the mains switch (34).
 - The vacuum process will not begin until the milling unit is activated.

2.4 Electrically connecting the unit

(see Fig. 3 on page 5 and Fig. 7 on page 10)

1. Connect the unit to mains (230V/50 or 60 Hz) using the mains cable included (socket [8]).
2. Turn on the mains switch (34). The indicator (35) will light in green.

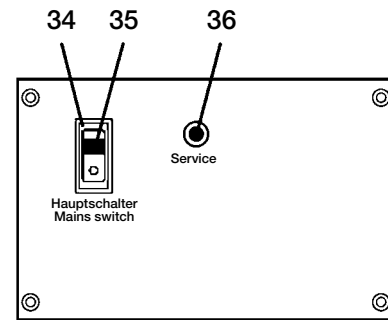

Fig. 3: Panel with control elements

- | | |
|----|------------------------|
| 34 | Mains switch |
| 35 | Mains switch indicator |
| 36 | Service indicator |

3 Operation

3.1 Checking the filtration module

(see Figs. 1 and 2 on page 6)

Caution: The CERCON CLEAN single-user vacuum-cleaning unit must not be operated without an ultra-fine filter (31) and a filter bag (11), both correctly installed and undamaged.

1. Open the two clamp locks (3) and remove the cover (2).
2. Check to ensure that the ultra-fine filter (31) is undamaged and tightly pressed against sealing surfaces (24) using the ledge (29).
3. Check to ensure that the two M6 nuts (28) are tightened firmly and equally.
4. Check to ensure that the mounting cover (5) is tightly screwed into place using the two thumb screws (6).
5. Check to ensure that the filter bag (11) is inserted properly in the basket (12) and that it is undamaged.

6. Check to ensure that the plastic connector (10) of the filter bags is seated tightly on the connecting duct (15).
7. Replace the cover (2) and close the two clamp locks (3).

3.2 Air volume control

Note: The fuller the filter bag (11), the less powerful the vacuum.

Thanks to the built-on power stabilizer, the preset input air volume is kept constant as the mains voltage changes (between 180 and 264 V).

3.3 Automatic turn-off and filter change indicator

(see Fig. 6 on page 9)

Note: As soon as the filter bags (11) has been filled to the maximum permissible, an underpressure switch will actuate the automatic turn-off function, and the filter change indicator on the milling unit will be lit. The vacuum will not be turned off until the milling procedure is completed. The milling unit can only be turned back on when the filter bag has been replaced or the ultra-fine filter cleaned.

1. The filter bag (11) has to be replaced, see Section 4.1.

Note: If the automatic turn-off function has turned off the unit, cycling the unit off and on and tapping the filter bag (11) will allow the operator to keep working for a little while longer without having to replace the filter bags.

2. To tap the filter bag (11), open the two clamp locks (3) and remove the cover (2) (see Figs. 1 and 2 on page 4).

Note: If the automatic turn-off function has turned off the unit (filter change indicator is lit) and the filter bag (11) turns out not to be full, the ultra-fine filter (31) must be checked (see Section 4.3).

4 Cleaning and maintenance

4.1 Replacing the filter bag

(see Figs. 1 and 2 on page 6 and Fig. 4 on page 8)

1. Open the two clamp locks (3) and remove the cover (2).
2. Use both hands to pull the plastic connector (10) off the duct (15).
3. Close the filter bag (11) using the attached plastic cover (17).
4. Carry the filter bag (11) to the designated disposal site within its basket (12) and dispose of properly.

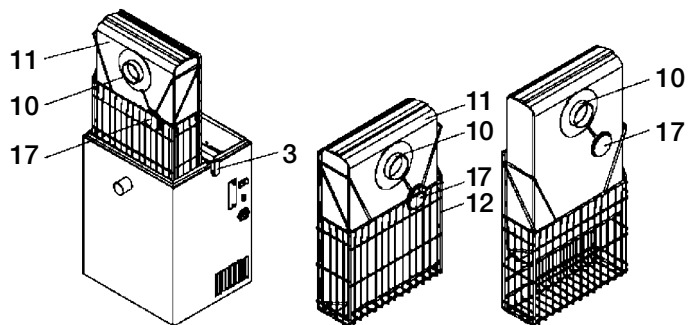

Fig. 4: Removing the filter bag

Caution: The single-use filter bags must never be emptied and reused. Not only might this constitute a health hazard, but it would also impair the function of the unit.

Caution: Do not use pressurized air to remove any dust present in the filtration chamber (20).

Do not allow any foreign matter to enter the air intake opening (26) because this might damage the vacuum motor.

5. Insert the new filter bag snugly and check the filtration module (see Section 4.2).

4.2 Inserting the filter bag

(see Fig. 1 on page 6 and Figs. 6 and 7 on page 9 and 10)

1. Fold new filter bag (11) as shown in Fig. 5 and insert into basket as shown (12).

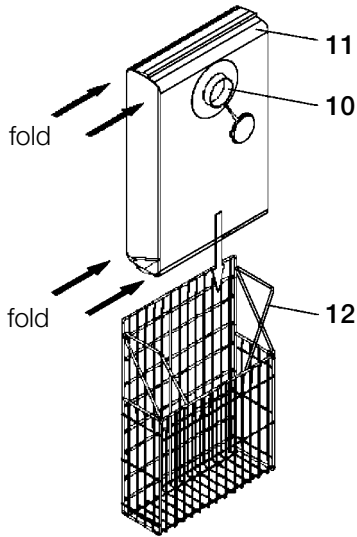

Fig. 5: Inserting the filter bag

2. Slide the new filter bag (11) in its basket (12) into the unit.
The duct of the filter bag (10) will engage the duct (15) inside the filtration chamber (20) tightly.
3. Slide the plastic connector (10) tightly onto the housing duct (15) of the vacuum unit.
4. Place the cover (2) on the housing (1) and tighten using the clamp locks (3).

4.3 Cleaning (replacing) the ultra-fine filter

(see Figs. 1 and 2 on page 6 and Fig. 6 on page 9)

Note: Approximately every tenth time the filter bag (11) is changed, the ultra-fine filter (31) should be removed and cleaned (dry cleaning process) or replaced.

We will be happy to clean the ultra-fine filters (31) for you by way of a filter exchange. In this way you can be certain that only type-tested filters pursuant to DIN EN 60 335-2-69 (ZH 1/487 para. 2 with a certificate pursuant to DIN 24184) are used.

1. Open the two clamp locks (3) and remove the cover (2).
2. Open and remove the thumb screws (6) and mounting cover (5).
3. Loosen the two nuts (28) and lift out the ledge (29) with the longitudinal holes.
4. Remove the ultra-fine filter (31).

Caution: No dust may be present on the sealing surfaces (24) or in the air intake chamber (32), as the dust may damage the vacuum motor (23).

The air intake chamber (32) and sealing surfaces (24) must be cleaned by vacuuming. Do not use pressurized air.

5. Insert the cleaned or new ultra-fine filter (31).
6. Slide the ledge (29) onto the threaded pins from above.
7. Tighten the two M6 nuts (28) firmly and equally.
8. Tightly screw the mounting cover (5) into place using the two thumb screws (6).
9. Check the filtration module (see Section 3.1).

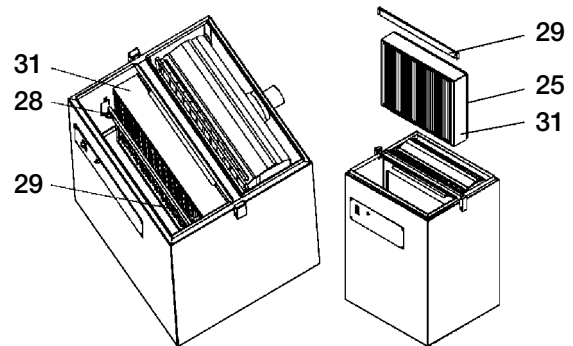

Fig. 6: Changing the ultra-fine filter

4.4 “Service” indicator

(see Fig. 3 on page 7).

If the “Service” indicator is lit, the vacuum motor (23) needs replacing.

The vacuum motors must be checked – and if necessary replaced – by a specialist.

Note: Follow the “CERCON CLEAN single-user vacuum-cleaner unit troubleshooting checklist” during all maintenance and service work.

5 Electrical protection

The entire unit is electrically protected using two fine-wire fuses (main fuse) 6.3 A/T. The two fuses are located in the fuse drawer (40) inserted in the primary power socket housing (8) ist.

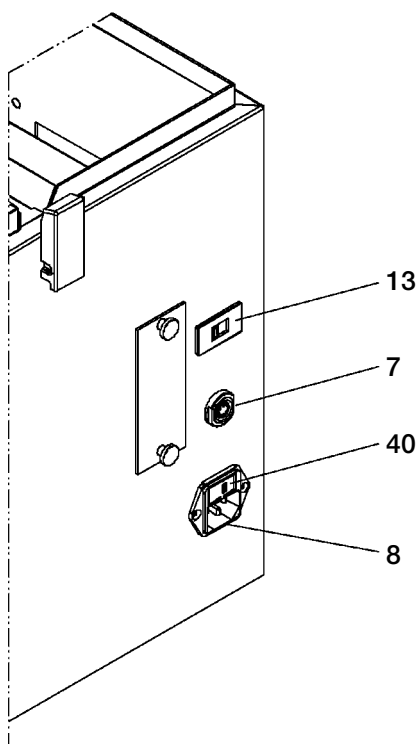

Fig. 7: Electrical protection

- 7 Control cable socket
- 8 Primary power socket
- 13 Frequency selector 50/60 Hz
- 40 Fuse drawer with fuses 6,3 A/T (2 ea.)

6 Technical specifications

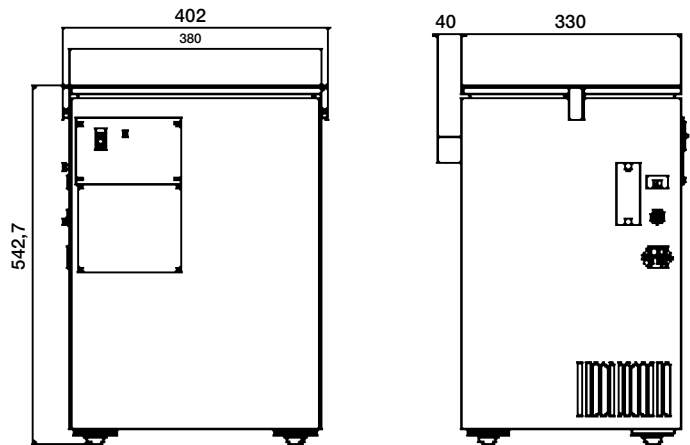

Fig. 8: Dimensions of the vacuum-cleaning unit

Designation of the unit	Single-user vacuum-cleaning unit
Unit type	CERCON CLEAN 230 VAC
Dimensions	420 mm wide (including mains cable relief), 390 mm deep (with vacuum duct), 540 mm high
Voltage	200 + 240 Volt (50/60 Hz)
Overvoltage category	II
Power requirements	Max. 800 W
Air throughput	max. 40 l/s
Noise level	61 dB(A)
Vacuum duct connector	40 mm diameter
Dust uptake	Up to approximately 10 kg (depending on the type of dust)
Electrical protection	2x 6,3 A/T (mains connection)
Weight	ca. 25 kg

7 Warranty conditions

This unit complies with present-day safety requirements and has been tested extensively before leaving the factory. We offer you a 24-month warranty and undertake to perform, free of charge, any repairs that may become necessary due to defects in material or workmanship.

This warranty shall be void in the event that the repairs are not performed either by ourselves or by an authorized reseller.

The provision of spare parts under this warranty does not extend the original warranty period.

Normal wear and tear (brushes of the vacuum motor) or damage caused by improper operation are not covered by this warranty.

To be able to offer you our comprehensive service, we ask you to return to us the warranty slip (inserted in the front of these Instructions for Use) by fax or mail.

Fax Fax 01 80-23 24 556

	Designation of the unit Single-user vacuum-cleaner unit
Duplicate	Unit type CERCON CLEAN 230 VAC
Warranty Slip	Unit No.
	Date of purchase
DeguDent GmbH	Reseller/depot
Rodenbacher Chaussee 4	
P.O. Box 13 64	Sender
63403 Hanau	
Germany	
	Date/Signature

8 EU Declaration of Conformity pursuant to EC Machine Directive 98/37/EC

We declare that the machine described below conforms to the basic health and safety requirements of the EC Directives in design and construction.

This declaration shall be void if the machine is subjected to any modifications not authorized by us.

Manufacturer's name DeguDent GmbH
 Manufacturer's address Rodenbacher Chaussee 4,
 P.O. Box 13 64, 63403 Hanau,
 Germany
 Designation of the unit Single-user vacuum-cleaner unit
 Unit type CERCON CLEAN

The following EC directives were applied:

EC Machine Directive (98/37/EC)

EC Low-Voltage Directive (73/23/EEC) corresponding to the First Ordinance Concerning the German Appliance and Equipment Safety Law (1. GSG-Verordnung) dated 11 June 1979

EC EMC Directive (89/336/EEC), corresponding to the German EMC law dated 9 November 1992

The following harmonized standards were applied:

DIN EN 292	Safety of machinery
DIN EN 61 010-1	Safety requirements for electrical equipment for measurement, control, and laboratory use
DIN EN 55 014	Electromagnetic compatibility – Requirements for household appliances, electric tools and similar apparatus, radio interference/interference power
DIN EN 55 104-2	Electromagnetic compatibility, immunity requirements, immunity, ESD/burst/surge
DIN EN 61 000-3-2/A14	Mains feedback/harmonics/flicker

The following national technical standards were applied:

DIN EN 60335-2-69 (ZH 1/487)	Equipment for the separation of hazardous dust and for returning the purified air to the working area
------------------------------	---

A Technical Documentation exists.

The Instructions for Use pertaining to the machine is present.

Hanau, 7 Feb 2005

 Dr. Udo Schusser
 Research & Development

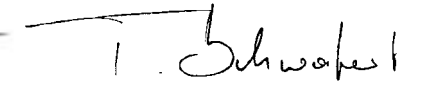
 Torsten Schwafert
 Head of Dental Engineering Division

For further information
or for placing an order:
www.cercon-smart-ceramics.com

cercon
smart ceramics®